

Tahiti, Society Islands

| Facilities | |
|-----------------|-------------------|
| Business Centre | ✓ |
| Electricity | 220V / 110V |
| Fitness Centre | ✓ |
| Ice machines | ✓ |
| Infinity Pool | ✓ |
| Laundry service | ✓ |
| Safety Boxes | at Reception Desk |
| Spa | Manea Spa |
| Waiting Lounge | ✓ |

| Room Facilities | |
|--------------------------|---------------------------|
| Air Conditioning | ✓ |
| Balcony | All except Superior Rooms |
| Bathrobes | in Duplex Rooms only |
| Bathtub | ✓ |
| Cable TV - Movie Channel | ✓ |
| Ceiling Fan | ✓ |
| Coffee / Tea Facilities | ✓ |
| Connecting Rooms | ✓ |
| Cooking Facilities | All except Superior Rooms |
| DVD Player | ✓ |
| Electronic razor outlet | 220V / 110V |
| Hair Dryer | ✓ |
| In-house Video Chanel | ✓ |
| Internet access | Wifi available |
| Iron | ✓ |
| Microwave | All except Superior Rooms |
| Refrigerator | All except Superior Rooms |
| Shower | ✓ |
| Telephone | ✓ |
| Terrace | All except Superior Rooms |
| TV | LCD flat screen |

| Free Activities | |
|------------------------|----------|
| Beach Towels | provided |
| Snorkeling Equipment | ✓ |
| Tahitian dance lessons | |
| Tennis court | |

Slated for spring 2009 opening, the Manava Suite Resort Tahiti promises to be the premier Papeete resort for business and leisure travelers alike, offering 121 guest rooms. All guest rooms will reflect authentic Polynesian décor, while still offering contemporary amenities and the comforts of home. The four star resort will encompass five separate buildings located in the island's northwestern region, in the community of Punaauia.



Location

5 minutes from airport. 10 minutes from downtown.

Credit Cards

Visa, Mastercard, American Express, Diners Club, JCB, Travellers Cheque

Services

| | | |
|----|--------------------------------------|-----------|
| 12 | Standard Room | 2010/2011 |
| 12 | Superior Room | 2010 |
| 20 | Garden Studio with kitchen | 2010/2011 |
| 30 | Lagoon Studio with kitchen | 2010/2011 |
| 20 | Garden Suite with kitchen | 2010/2011 |
| 24 | Lagoon Suite with kitchen | 2010/2011 |
| 4 | One-Bedroom Duplex with kitchen | 2010/2011 |
| 4 | Two-Bedroom Duplex with kitchen | 2010/2011 |
| 4 | One-Bedroom Apartment with kitchen | 2010/2011 |
| 2 | Two-Bedroom Apartment with kitchen | 2010/2011 |
| 1 | Three-Bedroom Apartment with kitchen | 2010/2011 |

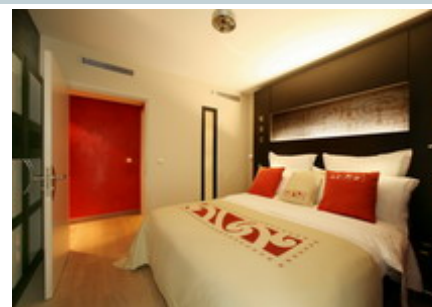

Wedding and romance information

Romantic Rendez-vous, Escapades, Spa & Massage, Polynesian Wedding Ceremonies

Conferencing information

One conference room up to 80 pax, theatre style.

Dining information

Restaurant:

Open for Breakfast Buffet, Lunch & Dinner à la carte

* Breakfast from 06:30am to 10:00am

* Lunch from 11:30pm to 04:00pm

* Dinner from 06:30pm to 09:30pm

Room service available from 06:00am to 10:00pm.

Bars information

Taapuna Pool Bar: open every day from 10.00am to 05.00pm

Matatia Lounge Bar: open every day from 04.00pm to 11.00pm

More Information

Check-in: 02.00pm
Check-out: 11.00am

* FACILITIES FOR THE DISABLED *

Some rooms are equipped with an access ramp, wide doors and entryway, raised toilets and retractable armrests. Public areas and pool are easily accessible. Wide cement paths. Elevator in each building with access to each level.

Terms of Trade(e.g. Deposit Policy, Cancellation Policy, Purchase Policy)

2010 (valid from April 01st) FIT Cancellation policy. For any cancellation received:

- within 7 days: 1 night fee

- no show : Full stay will be charged

Early check-outs will be subject to a cancellation fee equal to 100% of the remaining nights



- ① - Entrance - Lobby / Entrée - Lobby
- ② - Fitness Center / Salle de Fitness
- ③ - Conference Rooms / Salles de Conférences
- ④ - Garden View Rooms / Chambres Vue Jardin
- ⑤ - Lagoon View Rooms / Chambres Vue Lagon
- ⑥ - Swimming Pool / Piscine
- ⑦ - Pool Bar / Bar de la piscine
- ⑧ - Overwater Restaurant / Restaurant sur le lagon
- ⑨ - Overwater Bar / Bar sur le lagon
- ⑩ - Pontoon / Ponton Nautique

Standard Room

2010/2011

Interior: 30 m²

Standard yet comfortable. All units are located in the first building from the main entrance and have a mountain view.

Maximum Occupancy is : 2 adults and 1 infant.

Bed Configuration: 1 Queen bed or 2 single beds

Occupancy Details

Max Number Of Adults: 2

Max Number Of Adults and Child(ren): 3



Superior Room

2009/2010

Room Surface : 30m²

All units are located in the first building from the entrance and have a mountain view.

Bed Configuration: None Specified

Occupancy Details

Max Number Of Adults: 2

Max Number Of Adults and Child(ren): 2



Garden Studio with kitchen

2009/2010

Interior: 41m²

Terrace: 19 m²

This unit features a kitchenette including microwave, refrigerator, electric range, sink and a single sofa bed. Accessible to clients on wheelchair.

Bed Configuration: 1 Queen + 1 Sofa bed or 2 single beds + 1 sofa bed

Occupancy Details

Max Number Of Adults: 3

Max Number Of Adults and Child(ren): 3



Lagoon Studio with kitchen

2009/2010

Interior: 41m²
Terrace: 19 m²



This unit features a kitchenette including microwave, refrigerator, electric range, sink and a single sofa bed. Accessible for clients on wheelchair.

Bed Configuration: 1 Queen + 1 Sofa bed or 2 single beds + 1 sofa bed

Occupancy Details

Max Number Of Adults: 3

Max Number Of Adults and Child(ren): 3

Garden Suite with kitchen

2009/2010

Interior: 41m²
Terrace: 19 m²



This unit features a kitchenette including microwave, refrigerator, electric range, sink, a single sofa bed and nice view on hotel's garden. Accessible for clients on wheelchair.

Bed Configuration: 1 Queen + 1 Sofa bed or 2 single beds + 1 sofa bed

Occupancy Details

Max Number Of Adults: 4

Max Number Of Adults and Child(ren): 4

Lagoon Suite with kitchen

2009/2010

Interior: 59 m²
Terrace: 28 m²

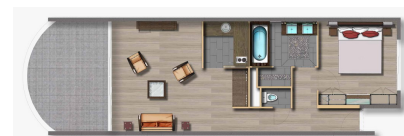

These Suites feature a kitchenette including microwave, refrigerator, electric range, sink, a double sofa bed and a beautiful view of the lagoon and the sister island.

Bed Configuration: 1 Queen + 1 Sofa bed or 2 single beds + 1 sofa bed

Occupancy Details

Max Number Of Adults: 4

Max Number Of Adults and Child(ren): 4

One-Bedroom Duplex with kitchen

2009/2010

Interior: 77 m².
Terrace: 19 m².



1st floor : kitchenette, sitting area, toilets.

2nd floor : 1 bedroom, 1 desk, 1 full bathroom, separate toilets and a sofa bed. Bathrobes and high end amenities provided.



Bed Configuration: 1 Queen + 1 Sofa bed or 2 single beds + 1 sofa bed

Occupancy Details

Max Number Of Adults: 4

Max Number Of Adults and Child(ren): 4

Two-Bedroom Duplex with kitchen

2009/2010

Interior: 139 m²
Terrace: 41 m²

First floor: kitchenette, sitting area, toilets and a double sofa bed.
Second floor: two bedrooms, one desk, two full bathroom & separate toilets.
This room category features bathrobes and high end amenities.

Bed Configuration: 2 Queen + 1 Sofa bed or 4 Single + 1 Sofa bed

Occupancy Details

Max Number Of Adults: 6

Max Number Of Adults and Child(ren): 6



One-Bedroom Apartment with kitchen

2009/2010

Interior: one unit with 47 m² and 3 units with 59 m².
Terrace: one unit with 11 m² and 3 units with 26 m².

These apartments are comfortable with a pretty nice view of the ocean from the 4th floor.
Sofa bed in living room.

Bed Configuration: 1 Queen + 1 Sofa bed or 2 single beds + 1 sofa bed

Occupancy Details

Max Number Of Adults: 4

Max Number Of Adults and Child(ren): 4



Two-Bedroom Apartment with kitchen

2009/2010

Interior: 66 m²
Terrace: 23 m²

Nice and comfortable apartment on the 4th floor with a kitchenette, one double sofa bed and a splendid view of the ocean.

Bed Configuration: 2 Queen + 1 Sofa bed or 4 Single + 1 Sofa bed

Occupancy Details

Max Number Of Adults: 6

Max Number Of Adults and Child(ren): 6



Three-Bedroom Apartment with kitchen

2009/2010

Interior: 106 m²
Terrace: 38 m²

Comfortable apartment with kitchenette suitable for families, 3 bedrooms, a double sofa bed.

Only one unit, located on the 4th floor.

Bed Configuration: 1 Queen bed + 2 Double beds + 1 Sofa bed or 2 Single beds + 2 Double beds + 1 Sofa bed

Occupancy Details

Max Number Of Adults: 8

Max Number Of Adults and Child(ren): 8

