

Moorea, Society Islands

Located on the northern coast of Moorea, between the magnificent Cook's bay and Opunohu Bay, Hotel Hilton Moorea Lagoon Resort and Spa offers an exceptional white sand beach, crystal blue lagoon and lush tropical gardens. The resort features large bungalows, air conditioned, and decorated with a traditional style.



Hilton
Moorea Lagoon Resort & Spa



Location

15 minutes from airport / 25 minutes from pier

Credit Cards

Visa, Mastercard, American Express, Diners Club, JCB, Travellers Cheque

Facilities	
Baby bed	
Baby sitting	On Request
Boutiques	✓
Business Centre	✓
Dive Centre	✓
Electricity	220V-110V
Fitness Centre	✓
Helipad	✓
Ice machines	✓
Infinity Pool	✓
Laundry service	✓
Spa	✓
Transit rooms	
Room Facilities	
Air Conditioning	✓
Bathtub	✓
CD Player	✓
Ceiling Fan	✓
Coffee / Tea Facilities	✓
Direct Access to Lagoon	overwater bungalows
Hair Dryer	✓
Internet access	✓
Iron	✓
Mini Bar	✓
Private pool	
Safety box	✓
Shower	✓
Telephone	✓
TV	✓
Free Activities	
Beach Towels	provided
Fitness Centre	✓
Kayaks, canoes	✓
Outrigger canoe	✓
Pedal Boat	✓
Sauna	✓
Snorkeling Equipment	✓
Volleyball	✓

Services

17	Overwater Bungalow	2010/2011
20	Garden Bungalow with Pool	2010/2011
1	Deluxe Garden Bungalow	2010/2011
26	Deluxe Garden Bungalow with Pool	2010/2011
3	Lagoon Bungalow	2010/2011
37	Panoramic Overwater Bungalow	2010/2011
*	Spa & Massages	2010/2011



Wedding and romance information

Romantic Touches, Spa

Dining information

ARII VAHINE (Lagoon side - First Floor - 120 seats):

Polynesian & International Cuisine
- Breakfast from 06:30am to 11:00am
- Dinner from 06:30pm to 09:30pm

ROTUI GRILL (By the pool - 60 seats):
Grill & Local & International Cuisine
- Lunch from 10:00am to 05:30pm

Room Service : from 06:00am to 10:00pm

Theme Dinners with Polynesian show available.

Bars information

ROTUI : from 11:00am to 09:00pm
EIMEO : from 05:00pm to 11:00pm

TOATEA OVERWATER BAR: from 07:00pm to 09:30pm & from 06:00pm to 10:00pm (except on Tuesday and Saturday).

Conferencing information

Extensive A/C meeting and banquet facilities for up to 100 people. Meeting equipment available. Outdoor functions for up to 200 people.

More Information

Check in: 02:00 PM
Check out: 11:00 AM

* FACILITIES FOR THE DISABLED *
2 Garden bungalows and 2 Overwater bungalows are equipped for the disabled.

Terms of Trade(e.g. Deposit Policy, Cancellation Policy, Purchase Policy)

2010 FIT cancellation policy (valid from April 01st). For any cancellation received:
* within 7 days: 1 night fee
* No show: full stay will be charged
* Early check-out: will be subject to a cancellation fee equal to 100% of the remaining nights.
Note: guests that no-show, and arrive unscheduled on days following, will still be charged no-show fees.

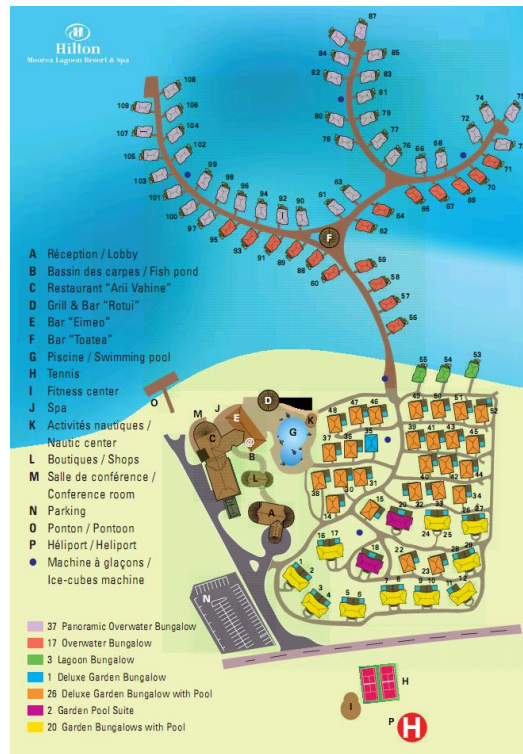

Overwater Bungalow

2008/2009

Room Surface: 47m²

Water around is 1,20 to 1,60 m deep

Spacious bungalow with exotic decoration and a very nice view of the lagoon. This extraordinary accommodation enables clients to enjoy a high state of relaxation.

Bed Configuration: 1 King bed + 1 sofa bed

Occupancy Details

Max Number Of Adults: 3

Max Number Of Adults and Child(ren): 3

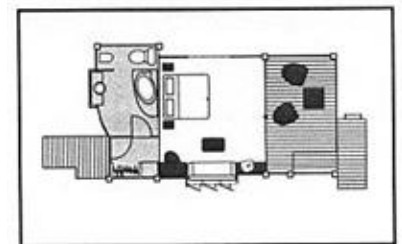

Overwater Bungalow

Garden Bungalow with Pool

2010/2011

Surface : 88 m²

Located in a lush garden, these bungalows have been refurbished to add a private swimming pool with sun deck. Bungalows are nicely decorated and equipped with LCD TV screen, DVD and CD player. These units are connecting bungalows that can be booked separately.

Bed Configuration: 1 double bed or 2 single beds + 1 sofa bed

Occupancy Details

Max Number Of Adults: 2

Max Number Of Adults and Child(ren): 2

Deluxe Garden Bungalow

2010/2011

Surface : 88 m²

Nicely decorated and well equipped, this bungalow is located in the lush garden of the resort.

Bed Configuration: 1 double bed + 1 Sofa bed

Occupancy Details

Max Number Of Adults: 3

Max Number Of Adults and Child(ren): 4

Deluxe Garden Bungalow with Pool

2010/2011

Surface: 88 m²

Relax, surrounded by the lush tropical gardens on your private deck with pool. With LCD TV, DVD & CD player, entertainment is taken care of and now with the time to unwind, the claw foot tub offers a relaxing long soak.

Bed Configuration: 1 double bed

Occupancy Details

Max Number Of Adults: 3

Max Number Of Adults and Child(ren): 4

Lagoon Bungalow

2010/2011

Surface: 62 m²

Nestled between the beach and lagoon, relax with views of the lagoon on your private deck. With LCD TV, DVD & CD player, entertainment is taken care of and now with the time to unwind, the claw foot tub offers a relaxing long soak.

Bed Configuration: 1 double bed + 1 Sofa bed

Occupancy Details

Max Number Of Adults: 3

Max Number Of Adults and Child(ren): 4

Panoramic Overwater Bungalow

2010/2011

Surface: 62 m²

With uninterrupted panoramic views across the ocean, these over water bungalows feature all you need to help you relax, from a claw foot bathtub to LCD TV, DVD & CD player and sun lounges. With mask & snorkel provided and private sun deck with direct access to the lagoon, meeting the fishes face to face is easily done or there is always the glass viewing panel in the room for a birds eye view.

Bed Configuration: 1 King bed + 1 sofa bed

Occupancy Details

Max Number Of Adults: 3

Max Number Of Adults and Child(ren): 4

Spa & Massages

2008/2009

The Moorea Lagoon Spa at the Hilton Moorea Lagoon Resort & Spa embraces healing traditions of the islands to create exotic treatments using local ingredients.

Treatments can be experienced at the spa or in the privacy of your own room.

The ultimate experience for those seeking exclusive honeymoon escape or simply an escape from the stresses of everyday life.

Occupancy Details

Max Number Of Adults: 999

Max Number Of Adults and Child(ren): 999

